

# DEPRAG

## Operating Instruction Booklet

### Flow Sensor

NW 7,2

NW 5,0

NW 2,7

361645 A

361645 B

361645 C

Dear Customer:

This tool is the result of more than 70 years of experience in the design and manufacturing of pneumatic tools for the industrial market.

We kindly ask that you read these operating instructions carefully so that you will be able to use this tool safely and for many years to come. If you need additional information, please contact your DEPRAG

Representative, one of our international support offices or us direct at DEPRAG. We will be happy to answer any questions. Please visit our web site: [www.deprag.com](http://www.deprag.com)

## Content

1	GENERAL INFORMATION .....	3
1.1.	General Safety Tips .....	3
1.2.	Owner Obligation .....	4
1.3.	Operator Obligation .....	4
1.4.	Warranty and Liability .....	5
1.5.	Symbol Description .....	6
1.6.	Observe Environmental Regulations .....	8
2	FLOW SENSOR COMPONENTS .....	9
3	FLOW SENSOR CONNECTION .....	10
4	FUNCTION OF FLOW SENSOR .....	11
5	PIN LAYOUT OF PLUG .....	12
6	CONTROL DIAGRAM .....	12
7	DELIVERY CAPACITY .....	12
8	STORAGE .....	13
9	TECHNICAL DATA .....	13
10	DISPOSAL .....	13
11	SERVICE LOCATIONS AND AUTHORIZED PARTNERS .....	14

## 1 General Information

The flow sensor allows to control the air flow in conjunction with pneumatic screwdrivers and other pneumatic devices.

### 1.1. General Safety Tips



**Please read the provided Operating Instruction Booklet carefully and adhere to all safety information, prior to operating this device.**

All items which directly relate to the safety of the Operator and the error-free operation of the flow sensor, are marked in the Operation Instructions with:

!

The flow sensor was designed and built to be primarily used in conjunction with the DEPRAG pneumatic tools (“intended use”).

“Intended use” also includes the strict observance of all operating instructions given by the manufacturer.

Any arbitrary modification of the sensor will void the manufacturer’s liability for all damages resulting from such modification.

!

This flow sensor has been designed and constructed for the sole purpose of use in conjunction with DEPRAG air-operated machinery (designated use). The use of this device in any other way is not acceptable. Furthermore,

!

When installing this device, make sure that the flow sensor is connection to the airline, prior to connecting the device to the electrical outlet.

When connecting directly (i.e. without coupler) into the airline, make sure that the airline is not under pressure.

## 1.2. Owner Obligation

The owner is obliged to only let persons operate the equipment, who

- are familiar with basic work environment safety rules and accident-preventing regulations. Also, those persons must have been instructed in the correct use of the equipment.
- have read and understood all safety and warning notifications in the Operating Instruction Booklet, as well as all other documentation pertaining to this equipment.
- check and confirm at regular intervals, that a safety oriented operation is guaranteed.

Only qualified and authorized personnel is allowed to operate, maintain and repair this equipment. A malfunction, which impairs operator safety, must be immediately removed.

## 1.3. Operator Obligation

Personnel, who is engaged in the operation of the equipment, must always be committed to

- observe the basic safety and accident preventing regulations,
- read and observe the safety and warning notifications of this operating instruction booklet.

## 1.4. Warranty and Liability

Unless otherwise specified, our “General Sales and Delivery Conditions” apply. Warranty and liability claims in regards to persons or equipment damages are invalid, if one or several of the following causes apply:

- Use of the equipment in a non-designated application.
- Improper installation, operation, service or maintenance of the machine.
- Operation of the machine with either defective or removed safety and protection devices.
- Non-observance of the requirements stated in the operating instruction booklet, in regards to transportation, storage, mounting, installation, operation, maintenance and service of the equipment.
- Structural change or adjustment on the equipment to a non-designated use.
- Inadequate supervision of wear parts.
- Improper repair, inspection or maintenance.
- Catastrophic cases because of a war, acts of god or other reasons which are beyond our control.

## 1.5. Symbol Description



Read and observe the Operating Instruction Booklet, prior to and during operation of tool.



### **DANGER**

Reference to an immediate danger to a person. May lead to serious injuries or even death, if unobserved!



Properly recycle environmentally damaging grease, cooling agents or detergents



### **RECOMMENDATIONS**

Important or additional information on the equipment or in the documentation



Use eye protection or wear safety goggles



Wear hearing protection



Warning against hand-injuries.

Attention: Keep away your hands from areas, which are marked with this symbol!

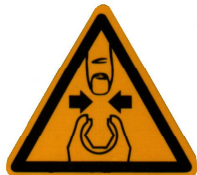

Hands may be crushed, seized or otherwise injured.



## ESD-protected area

Equipment may be damaged or destroyed by an electrostatic discharge.

Maintenance and repair on hydraulic and pneumatic equipment may only be performed by specially trained personnel!



Disconnect equipment from air supply, prior to repair of pneumatic or hydraulic equipment.

Provide regular preventive maintenance on hoses and airlines. Exchange hose lines, even if there is no visible damage! (Observe corresponding requirements of the manufacturer!)

After repair and maintenance, check the following items:

- make sure all detached and re-attached connections are solid.
- confirm that removed covers, screens or filters were re-installed
- During disconnecting or reconnecting of an air-operated equipment, injury may occur due to a whipping air-hose

After conclusion of maintenance or repair and prior to start of operation, make sure to

- remove all materials, tools and other supplies needed for the maintenance or repair from work area of the equipment
- remove leaking liquid or oils
- make sure all safety devices on the equipment work perfectly!

## 1.6. Observe Environmental Regulations



When working on or with the equipment, it is imperative to observe all requirements in regards to waste-disposal and proper recycling.

Especially during installation, repair or maintenance, water damaging agents such as

- lubricating grease and oil
- hydraulic fluid
- cooling agents
- solvent-containing cleaning agents

must not leak into the ground or into the sewage system!

Such materials must be stored, transported, contained and recycled in suitable containers.

## 2 Flow Sensor Components

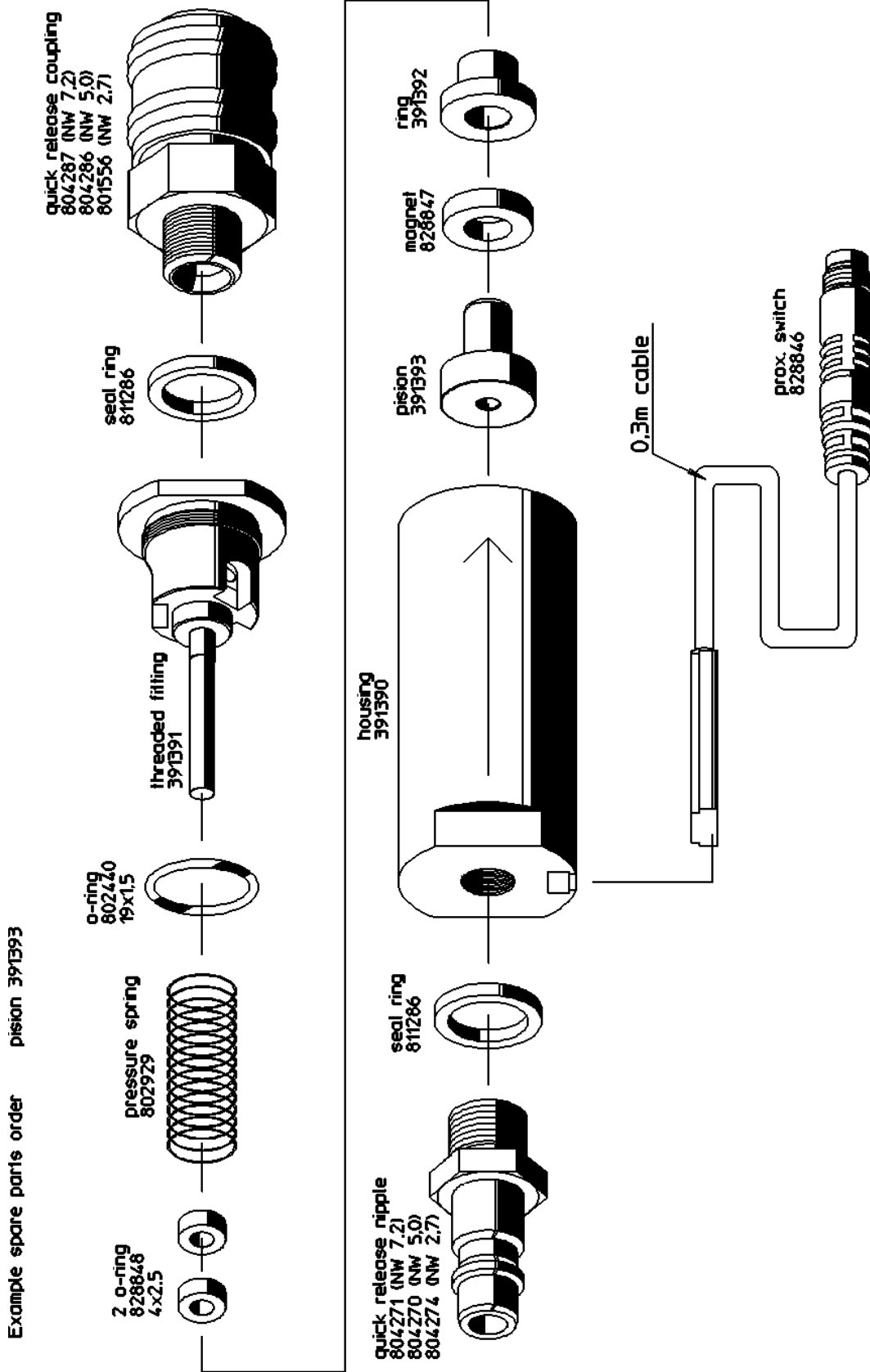



## Installation Tips:

1. The flow sensor is to be integrated between the valve and the pneumatic tool – as close to the air supply connection of the tool as possible.
2. The flow direction is shown in picture *Flow Sensor Connection*.
3. Principally, operation is permitted with filtered air (< 40 µm) only. Please also pay attention to the air quality required for the pneumatic tool.
4. The flow sensor should not be positioned within an induction field. The minimum distance to ferrous materials should be 20mm (see picture 3.2).
5. Observe the maximum rated values of Prox. Switch.

## 4 Function of Flow Sensor

The flow sensor functions as per the principle of the “suspended-body level measurement”. The “suspended body” (signal provider) contains permanent magnets. The air flowing in will move the signal provider in the direction of the air flow and the flow sensor will provide a signal (will be shown on integrated LED).

The proximity switch 828846 is a non-bridging contact and its lifetime will last for several millions of operations.

The flow sensor does not require any special servicing and is not intended to be disassembled by the customer. So in case of malfunction please return it to us (complete) for evaluation.

## 5 Pin Layout of Plug

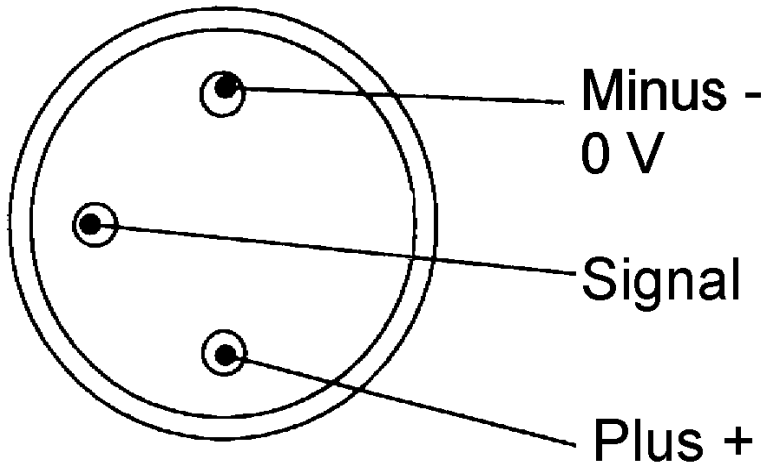

## 6 Control Diagram

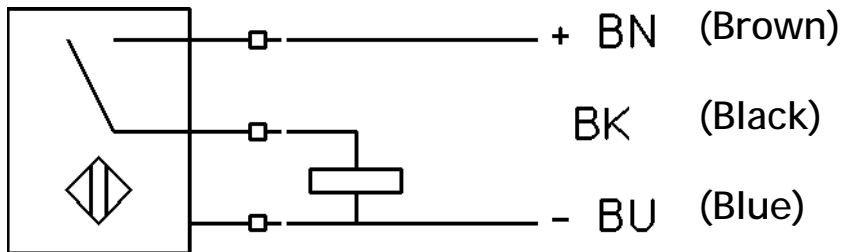

PNP NO

## 7 Delivery Capacity

Please check the delivery capacity in regards to its completeness.

QUANTITY	NAME	PART No.
1	Flow Sensor	361645 A/B/C
1	Operating Instruction Booklet	010734 EN

## 8 Storage

Unused machines should be stored in a dry, locked area.

## 9 Technical Data

**Manufacturer** DEPRAG SCHULZ GMBH u. CO.  
**Address** Kurfürstenring 12 - 18 Postfach 1352  
D-92224 Amberg D-92203 Amberg  
**Phone** 09621/371-0  
**Fax** 09621/371-120

Model No.	NW 7,2	NW 5,0	NW 2,7
Part No.	361645 A	361645 B	361645 C
Maximum Current	200 mA		
Maximum Voltage	10 –30 V		
Protection DIN 40050	IP 68		
Connector Cable Length	300 mm		
Electrical Connection	M8 x 1 screw-in and plug-in type		
Pneumatic Connection	by Coupler to Plug		
Operating Pressure	max. 6,3 bar		
Weight	0,172kg		
Standard Flow Capacity	0,8 Nm <sup>3</sup> /min	0,4Nm <sup>3</sup> /min	0,1Nm <sup>3</sup> /min

## 10 Disposal

Unused machines should be stored in a dry, locked area. Observe local and environmental regulations for the separation and recycling of materials.



**Recycle waste oil to avoid environmental contamination!**

## 11 Service Locations and Authorized Partners

### ARGENTINA

#### ERIN s.a.

Av. Constituyentes 5751  
RA-1431 Buenos Aires  
Tel./Fax: +54 (0) 11 / 4573.1313

### AUSTRIA

#### Amersin Olschinsky GmbH

Kastnerweise 1  
A-2441 Mitterndorf a.d. Fischa  
Tel.: +43 (0)1 / 8 69 87 66  
Fax: +43 (0)1 / 8 65 16 97  
Internet: <http://www.amersin.at>  
e-mail: [information@amersin.at](mailto:information@amersin.at)

### AUSTRALIA

#### De Rossi Industrial Pty. Ltd.

Unit 1 – 2 / 600 Liverpool Road  
Strathfield South, N.S.W. 2136  
Tel.: +61 (0)2 / 8732.7200  
Fax: +61 (0)2 / 8732.7299  
e-mail: [sales@derossi.com.au](mailto:sales@derossi.com.au)

### BELGIUM

#### Aijkens en Zumpolle B.V.

Postbus 29  
NL-5306 ZG  
Brakel/Niederlande  
Tel.: +31 (0)4 18 / 67 18 16  
Fax: +31 (0)4 18 / 67 32 17  
Internet: <http://www.zumpolle.net>  
e-mail: [info@zumpolle.net](mailto:info@zumpolle.net)

### BRAZIL

#### METALFEMA Ltda.

Rua Saõ Pedro, 786  
Saõ Leopoldo – RS –  
BRAZIL  
ZIP 93.010-260  
Tel.: +55 (0) 51 / 592.4050  
Fax: +55 (0) 51 / 590.1856  
e-mail: [mtfma@zaz.com.br](mailto:mtfma@zaz.com.br)

### PR CHINA

#### DEPRAG China

DEPRAG Assembly Technologies  
(Suzhou) Co.Ltd.  
No. 5, Xinghan St, Blk. A#06-16  
Suzhou 215021, P.R. China  
Tel.: +86 (0) 512 – 6767 – 1180 – 100  
Fax: +86 (0) 512 – 6767 – 1190  
Internet: [www.deprag.com.cn](http://www.deprag.com.cn)  
e-mail: [biz@deprag.com.cn](mailto:biz@deprag.com.cn)  
e-mail: [d.hua@deprag.com.cn](mailto:d.hua@deprag.com.cn)

### CROATIA

#### SM AUTOMATIKA D.O.O

Trg i. Kukuljevica 6  
HR-10090 Zagreb  
Tel.: +385(0)13 89 41 79  
Fax: +385(0)13 87 89 78  
Internet: <http://www.sm-automatika.hr>  
e-mail: [info@sm-automatika.hr](mailto:info@sm-automatika.hr)

### CZECHIA/SLOWAKIA

#### DEPRAG CZ a.s.

ul. T.G. Masaryka 113  
CZ -50781 Lázně Bělohrad  
Tel.: +420 (0) 4 93 / 79 24 11  
Fax: +420 (0) 4 93 / 79 25 12  
Internet: <http://www.deprag.com>  
e-mail: [info@deprag.cz](mailto:info@deprag.cz)

### DENMARK

#### DEPRAG Scandinavia AB

Gap Sundins väg 3  
SE-63346 Eskilstuna  
Tel.: +45 (0) 98 57 22 50  
Fax: +45 (0) 98 57 22 53  
Internet: <http://www.deprag.com>  
e-mail: [keld.branner@get2net.dk](mailto:keld.branner@get2net.dk)

### ESTLAND

#### Pneumacon OY

Läkkisepäntie 4  
FI-00620 Helsinki  
Tel.: +358 (0) 9 / 7288.160  
Fax: +358 (0) 9 / 7288.1610  
Internet: <http://www.pneumacon.fi>  
e-mail: [info@pneumacon.fi](mailto:info@pneumacon.fi)  
e-mail: [harry.lindroos@pneumacon.fi](mailto:harry.lindroos@pneumacon.fi)

### FINLAND

#### Pneumacon OY

Läkkisepäntie 4  
FI-00620 Helsinki  
Tel.: +358 (0) 9 / 7288.160  
Fax: +358 (0) 9 / 7288.1610  
Internet: <http://www.pneumacon.fi>  
e-mail: [info@pneumacon.fi](mailto:info@pneumacon.fi)  
e-mail: [harry.lindroos@pneumacon.fi](mailto:harry.lindroos@pneumacon.fi)

### FRANCE

#### DEPRAG Sarl

9, rue du Général Frère  
F-67500 Haguenau  
Tel.: +33 388 / 06.14.17  
Fax: +33 388 / 93.01.08  
e-mail: [depragfrance@evc.net](mailto:depragfrance@evc.net)

### GERMANY

#### Werk Amberg

Kurfürstenring 12-18,  
D-92224 Amberg  
Postfach 1352,  
D-92203 Amberg  
Tel.: +49 (0) 9621 / 3 71-3 71  
Fax: +49 (0) 9621 / 3 71-1 20  
Internet: <http://www.deprag.com>  
e-mail: [info@deprag.de](mailto:info@deprag.de)

### GREAT BRITAIN

#### DEPRAG Limited

Holly Farm Business Park  
Honiley, Kenilworth  
Warwickshire CV8 1NP  
Tel.: +44 (0) 1926 485480  
Fax: +44 (0) 1926 485481  
Internet: [www.deprag.co.uk](http://www.deprag.co.uk)  
e-mail: [m.searle@deprag.co.uk](mailto:m.searle@deprag.co.uk)

### GREECE

#### D. Panayotidis – J. Tsatsis s.a.

6 Pireos Street – Moschaton  
Athen  
Tel.: +30 (0) 1 / 4810.817-8-9  
Fax: +30 (0) 1 / 482 96 73

### HUNGARY

#### ADLER '91

Export/Import Kereskedelmi  
Takarék u. 18/B  
H-8800 Nagykanizsa  
Tel./Fax: +36 (0) 93 / 314 633  
e-mail: [adler91adlovits@chello.hu](mailto:adler91adlovits@chello.hu)

### Nóniusz Tool Trading House Ltd.

Köbányai út. 47/6  
H-1101 Budapest  
Tel.: +36 (0) 1 / 260 030 30  
Fax: +36 (0) 1 / 260 060 83  
Internet: <http://www.noniusz.hu>  
e-mail: [noniusz@noniusz.hu](mailto:noniusz@noniusz.hu)

### INDIA

LEAPTECH Corporation  
812 Cosmos, Sector – 11  
CBD Belapur  
New Mumbai – 400 614  
Tel.: +91 / 22 / 2756.2822/2849  
Fax: +91 / 22 / 2756.2881  
Internet: [www.leaptechcorp.com](http://www.leaptechcorp.com)  
e-mail: [leaptech@vsnl.net](mailto:leaptech@vsnl.net)

### DELHI office:

C-332, Sector – 10  
Noida – 201 301  
Tel.: +91 / 120 / 253.1393  
Fax: +91 / 120 / 253.1060

### BANGALORE office:

# 53, Anchor  
Suddagundapalaya  
C.V. Raman Nagar  
Bangalore – 560 093  
e-mail: [leaptechbq@vsnl.net](mailto:leaptechbq@vsnl.net)

### IRAN

#### FARA SANAT Co.

No. 117, Abzar & Yaragh passage  
Postcode 1136748173  
Tehran  
Tel.: 021 / 673.2918 / 670.6340  
Fax: 021 / 673.4757

### IRELAND

#### Production Equipment Ltd.

Riverside Commercial Estate  
IRL-Galway  
Tel.: +353 (0) 91 / 745 100  
Fax: +353 (0) 91 / 751 299  
e-mail: [sales@productionequipment.ie](mailto:sales@productionequipment.ie)

## ITALY

### DREX PALLOTTI S.r.l

Via A. Manzoni, 19  
I-20090 Vimodrone/Mi  
Tel.: +39 02 / 2740 0561 + 0569  
Fax: +39 02 / 2740 0607  
e-mail: [pallotti@drex.com](mailto:pallotti@drex.com)

### ATAX S.r.l.

Via Carolina Romani, 23  
I-20091 Bresso/Mi  
Tel.: 0039 02/ 61.03.48.61  
Fax: 0039 02/ 61.03.48.60  
e-mail: [info@atax.it](mailto:info@atax.it)  
Internet: [www.atax.it](http://www.atax.it)

## JAPAN

### NIPPON GESCO Ltd.

P.O. Box 255 Kyobashi Tokyo  
Ginza Matsuyoshi Bldg.  
17 - 8, 7-Chome, Ginza,  
Chuo-Ku, Tokyo  
Tel.: +81 (0) 3 / 3542.2400  
Fax: +81 (0) 3 / 3542.2420  
e-mail: [mail@gesco.co.jp](mailto:mail@gesco.co.jp)

## KOREA (South)

### Handtools

#### DONG WON POWER-TECH.INC.

108-10 Moonjung-Dong  
Songpa-Ku  
Seoul, Korea  
Tel.: +82 (0) 2 / 409.1344  
Fax: +82 (0) 2 / 409.1345  
e-mail: [kilpyungdw@dreamwiz.com](mailto:kilpyungdw@dreamwiz.com)

### Screwdriving / Assembly Technology

#### Fatec Co.Ltd.

#717 LG Palace B/D  
165-8 Dongkyo-dong  
Mapo-gu Seoul,  
Korea  
Tel.: +82 (0) 2 / 2 688.2152  
Fax: +82 (0) 2 / 2 688.2893  
e-mail: [fatec@chollian.net](mailto:fatec@chollian.net)  
e-mail: [fatec@fatec.co.kr](mailto:fatec@fatec.co.kr)

## LITHUANIA

### HIDROTEKA

P.O. Box 572  
LT-3028 KAUNAS  
Tel.: +370 (0) 37 / 352195  
Fax: +370 (0) 37 / 351952  
e-mail: [hidroteka@hidroteka.lt](mailto:hidroteka@hidroteka.lt)

## LUXEMBOURG

### Comptoir Technique et Industriel

321, Route d'Arlon  
L-8011 Strassen  
Penang, MALAYSIA  
Tel.: +352 / 31 31 40  
Fax: +352 / 31 31 95

## MALAYSIA

### FI INNOVATION ENTERPRISE

175, MK D Jalan Bahru  
Balik Pulau 11000  
Penang, MALAYSIA  
Tel. +60/13/ 449.0386 / +60/16/ 403.6797  
Fax: +60/4/ 866.0785  
e-mail: [farisfi@tm.net.my](mailto:farisfi@tm.net.my)

## NETHERLANDS

### Zumpolle B.V.

Postbus 29  
NL-5306 ZG  
Brakel/Niederlande  
Tel.: +31 (0) 4 18 / 67 18 16  
Fax: +31 (0) 4 18 / 67 32 17  
Internet: <http://www.zumpolle.net>  
e-mail: [info@zumpolle.net](mailto:info@zumpolle.net)

## NORWAY

### Deprag Scandinavia AB

Gap Sundins väg 3  
SE-63346 Eskilstuna  
Universal Import  
Tel.: +47 (0) 2 / 2681.530  
Fax: +47 (0) 2 / 2199.127

## POLAND

### ELKREM SPOLKA Z O.O.

ul. Wielki Row 40B  
87-100 Torun  
Tel.: +48 / 56 / 662.3881  
Fax: +48 / 56 / 662.3882  
e-mail: [elkrem@to.onet.pl](mailto:elkrem@to.onet.pl)

## PORTUGAL

### Anibal Pires Lda.

A.P. 23  
E.N. 1 - Mourisca do Vouga  
P-3750 TROFA AGD  
Tel.: +351 (0) 234 / 646.820  
Fax: +351 (0) 234 / 646.815  
Internet: <http://www.anibalpires.pt>  
e-mail: [anibalpires@mail.telepac.pt](mailto:anibalpires@mail.telepac.pt)

## SINGAPORE

### Testel Systems Pte Ltd

1200 Depot Road # 04-07/09  
Singapore 109675  
Tel.: +65 / 6271-3688  
Fax: +65 / 6271-8866  
Internet: <http://www.testel.com.sg>  
e-mail: [sunny@testel.com.sg](mailto:sunny@testel.com.sg)

## SLOVENIA

### MB-NAKLO D.O.O.

Toma Zupana 16  
SLO-4202 NAKLO  
Tel.: +386 (0) 4 / 277 17 00  
Fax: +386 (0) 4 / 277 17 17  
e-mail: [mb-naklo@siol.net](mailto:mb-naklo@siol.net)

## SPAIN

### ALCOTAN SISTEMAS S.A.

pº de la Direccion, nmro. 95,  
local  
E-28039 Madrid  
Tel.: +34 91 / 311.17.84 + 311.18.01  
Fax: +34 91 / 311.60.53  
e-mail: [alcotansis@jazzfree.com](mailto:alcotansis@jazzfree.com)

## BARCELONA office:

Passeig de la Mare de Déu del  
Coll, 122-124  
E-08023 Barcelona  
Tel.: +34 93 / 2 85 50 34

## SWEDEN

### DEPRAG Scandinavia AB

Gap Sundins Väg 3  
S-633 46 Eskilstuna  
Tel.: +46 (0) 16-12 61 10  
Fax: +46 (0) 16-13 31 88  
Internet: <http://www.deprag.se>  
e-mail: [info@deprag.se](mailto:info@deprag.se)

## SWITZERLAND

### LIMATEC Automation AG

Burgunderstr. 13  
CH-4562 Biberist  
Tel.: +41 (0) 32 / 6542900  
Fax: +41 (0) 32 / 6542901  
Internet: <http://www.limatec.ch>  
e-mail: [office@limatec.ch](mailto:office@limatec.ch)

## TAIWAN

### I HEN MACHINE Co.Ltd.

6F-9, No. 12, Lane 609, Sec. 5  
Chung-Hsin Road,  
San-Chung City  
241 Taipei Hsen  
Tel.: +886 (0) 2 / 2999.6766  
Fax: +886 (0) 2 / 2999.6236

## TURKEY

### MEKA AUTOMOTIVE ASSEMBLY EQUIPMENTS

Dicle Caddesi, Tunca Sokak No : 6  
Beysukent - Beytepe - Ankara -  
TURKEY  
Tel.: +90 / 312 / 236 2558  
Tel.: +90 / 312 / 236 2559  
Fax: +90 / 312 / 236 0991  
Internet: [www.me-ka-assembly.com](http://www.me-ka-assembly.com)  
e-mail: [melih@me-ka-assembly.com](mailto:melih@me-ka-assembly.com)

## USA, MEXICO, CANADA

### DEPRAG INC.

645 Hembry St. / P.O. Box 1554  
Lewisville, TX 75057-4726  
Tel.: +1 / 972 / 221 - 8731  
Fax: +1 / 972 / 221 - 8163  
Toll Free: (800) 4 DEPRAG  
Internet: <http://www.deprag.com>  
e-mail: [deprag@depragusa.com](mailto:deprag@depragusa.com)

## VENEZUELA

### Suministros Tecnicos SUMTEC C.A.

Av. Francisco de Miranda, Centro Plaza  
Torre C, Piso 16, Oficina C16 A-B  
Urb. Los Palos Grandes  
Caracas 1060  
Tel.: +58 (0) 212 - 28 56 41 0  
Fax.: +58 (0) 212 - 28 51 94 7

# DEPRAG

**DEPRAG SCHULZ GMBH u. CO.**

Postfach 1352, D-92203 Amberg

Kurfürstenring 12-18, D-92224 Amberg

(09621) 371-0

Fax (09621) 371-120

Internet: <http://www.deprag.com>

e-mail: [info@deprag.de](mailto:info@deprag.de)



ZERTIFIZIERT NACH DIN EN ISO 9001

---

Jun-05 Änderungen vorbehalten / Technical alterations reserved